

## SHORELAND BUFFER PLAN

235 Piscataqua Rd  
Madbury, NH 03823

As a condition to adding a 391' sf deck to the waterside of our home at 245 Piscataqua Rd, all to be outside of the 50' Protected Shoreline Zone setback area, but within the 150' Shoreland Buffer Zone, we, the homeowners, have agreed to incorporate and 10' vegetative buffer zone at the water's edge. The area considered is the land 10 feet from the water's edge at the time of the Highest Observable Tide Line (HOTL). Currently, we have a chain link fence set approximately 4 feet from HOTL, behind which are plants, trees and shrubs that appear to be in their natural state (in other words, we don't mow, weed, prune or maintain the area). The 6 feet in front of the fence then is the area we propose to incorporate landscaping principles and materials consistent to preserving, protecting and enhancing the natural ecology of shoreland property.

I have purchased and reviewed the "Landscaping at the Water's Edge" manual from the UNH Cooperative Extension, and was thrilled to find that many of the improvements I have made to the property since 2007 were directly recommended in the manual. For example, we have built a dry stack retaining wall on the east side of the front driveway which both slows and diverts rainwater runoff and provides a playground for chipmunks and other wildlife. We have used granite stepping stones over a base of varying sized pebbles to construct a walkway from the front halfway to the water in the back providing a natural filtration system for runoff. Finally, based on the obvious erosion patterns in the back, I've begun to terrace the grade adding plants to the layers to further slow and use the rainwater.

The resulting plans then for the 6 feet in front of the fence are relatively simple based on the small area we're addressing. We propose to plant a hedge of beach roses (*Rosa Rugosa*) at the fence center and left looking out towards the water. These reach a height of 4' to 6' and will hide the fence while lending a final water capture area in front of the fence. Smaller False Blue Indigo groupings will bookend a couple large boulders, with day lilies in front. A smooth leaf hydrangea will be placed to the far left, closest to the gate on the west.

2 smooth leaf hydrangeas will frame the new location of the garden bench and ornamental grasses will line the fence to the just right of center. A few large granite stepping stones placed with generous spacing will provide a platform / walkway for the bench with spreading thyme allowed to grow in the spacing.

Due to the majority of shade on the right side of the yard at the fence, we have chosen to move the existing hostas and rhodies to the fence line as a final barrier, and use 1-2 Virginia Sweetspires as fillers.

The entire area will be intermittently planted with clumps of *deutzia nikko*, a compact flowering groundcover. Fallen leaves will be allowed to congregate in the area providing natural mulching.

# CURRENT

EXISTING BUFFER CONSISTS OF GRANITE OUTCROPPING, TREES, AND SHRUBS

SLABS IN WATER

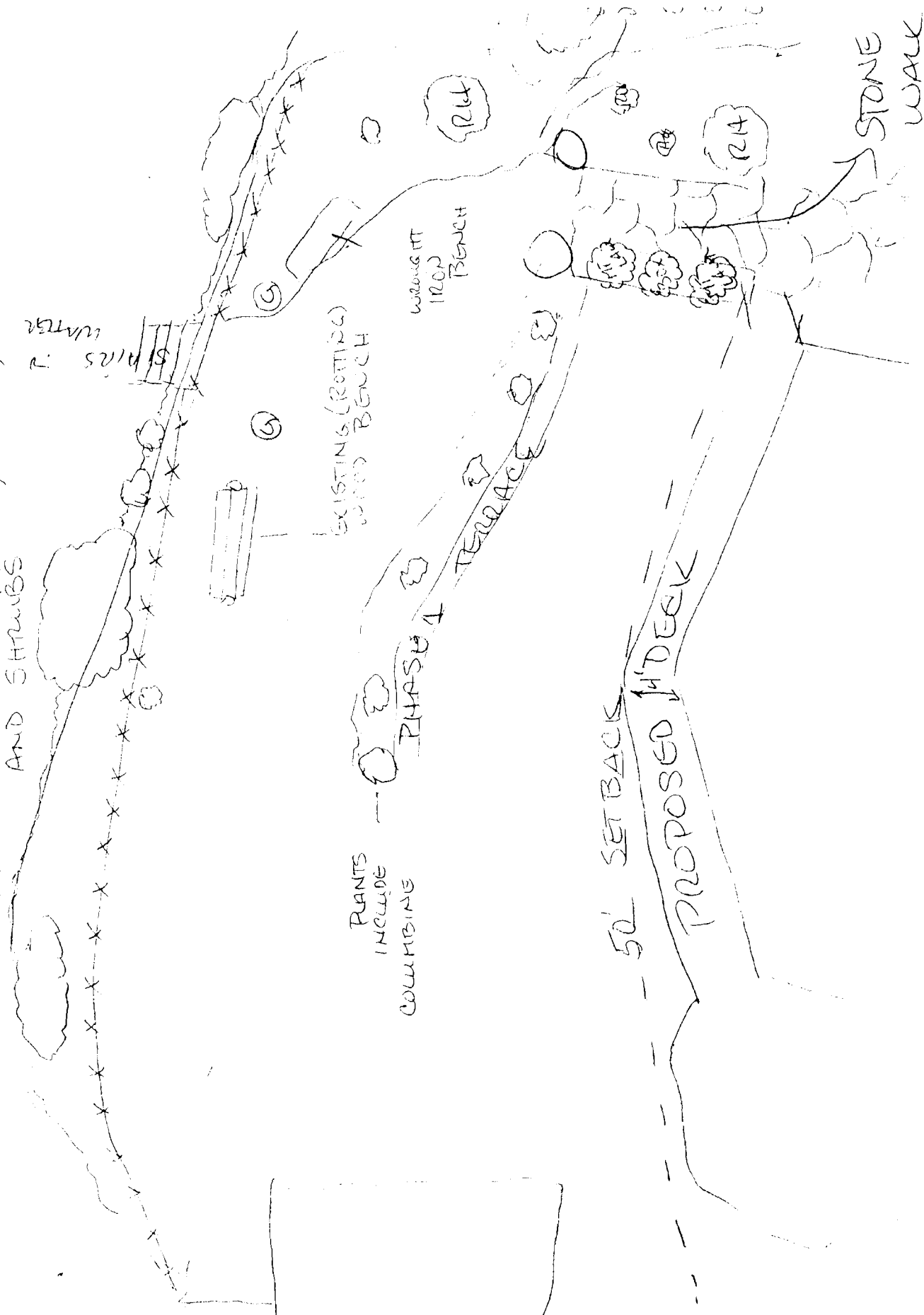

PLANTS INCLUDE COLUMBINE

EXISTING (ROTINA) WOOD BENCH

Washing IRON BENCH

50' SETBACK  
PROPOSED 4' DECK

STONE WALK

# PLANNED

EXISTING BUFFER CONSISTS OF GRANITE OUTCROPPING, TREES, AND SHRUBS

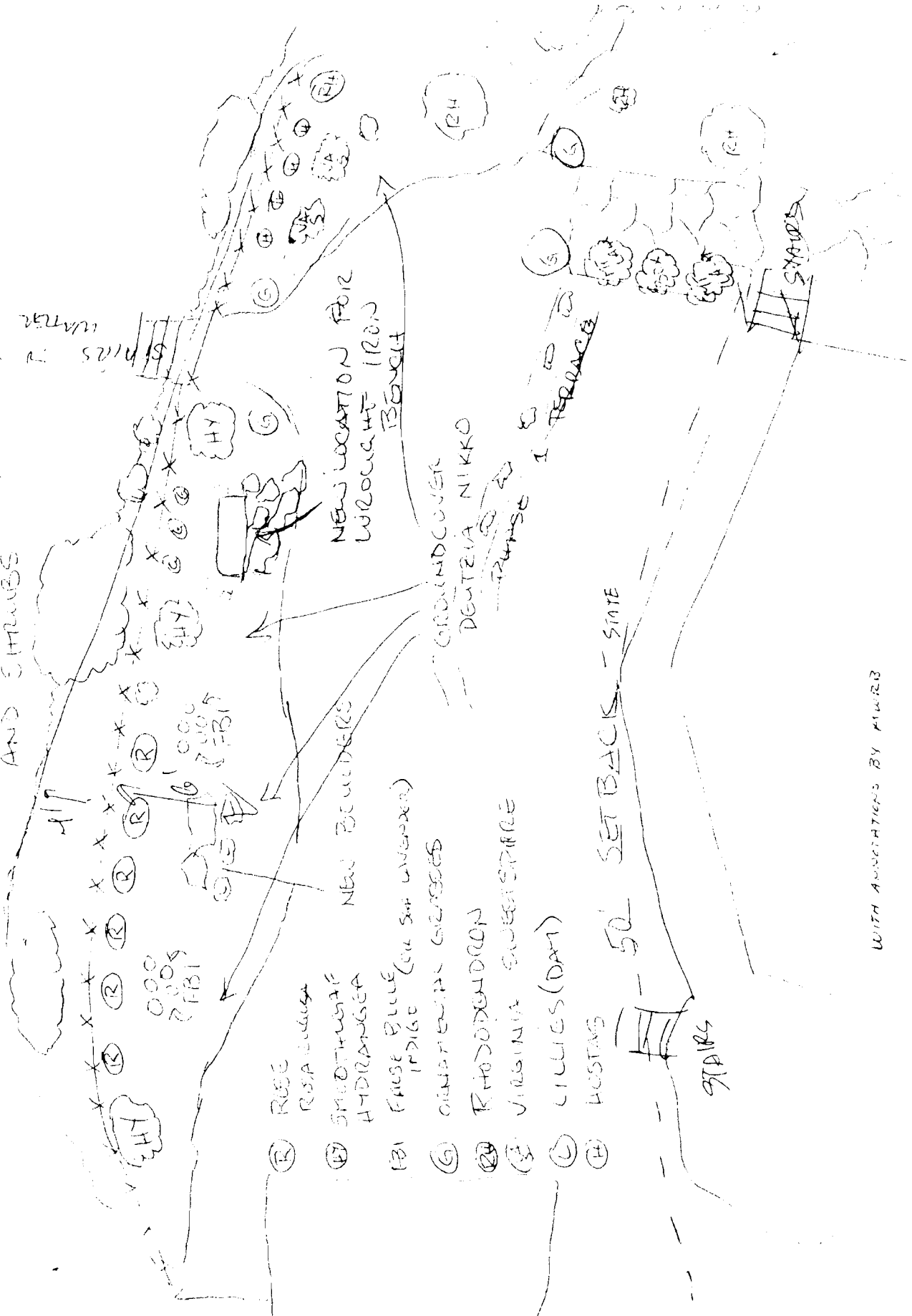

WITH ADJUSTMENTS BY PLUMB